

# Assembly instructions

## MALLEE BENCH

### STEP 1: COMPONENTS

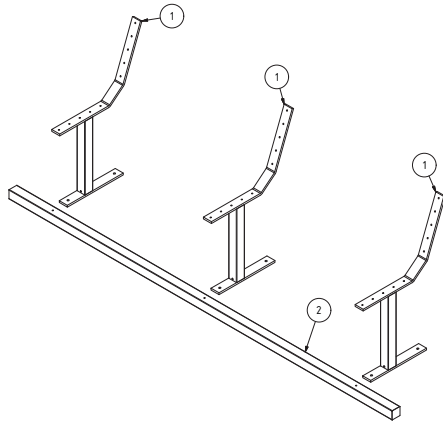

Lay a 50x50mm batten profile on the ground to assist with aligning the legs.

### STEP 2: ATTACHING SEAT BATTENS

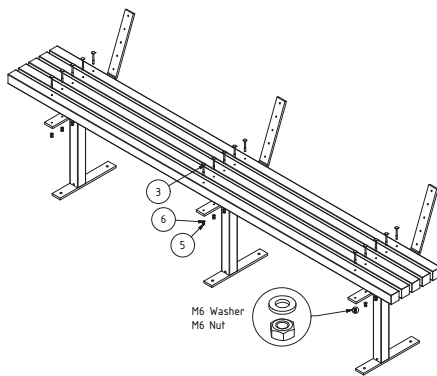

Place battens on legs. Lightly tap bolts through battens with hammer then secure using M6 nuts and M6 washers

### STEP 3: ATTACHING BACK BATTENS

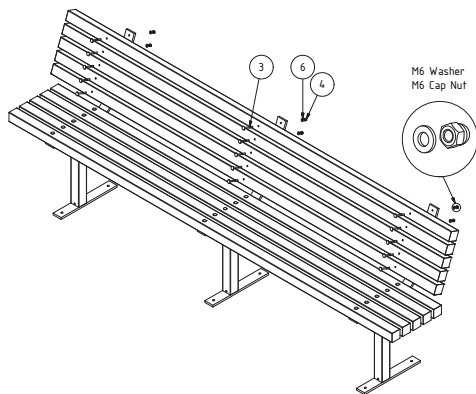

Place battens on back. Lightly tap bolts through battens and secure using hexagon dome capped nuts and M6 washers.

### FLAT PACKED SEAT ON ARRIVAL

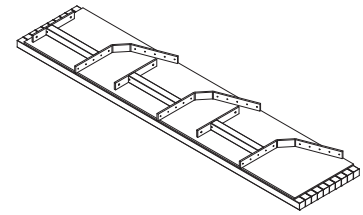

Parts List - Per Seat		
Item	Qty	Assembly Name
1	3	Galvanised steel legs
2	10	50x50x2400mm battens
3	30	M6x70mm coach bolts
4	15	Hexagon domed cap nuts
5	15	M6 nuts
6	30	M6 washers

### PROVIDED:

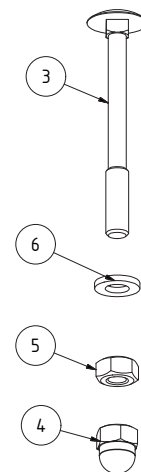

### TOOLS REQUIRED:

- Shifting spanner to tighten nuts.
- Hammer to tap bolts through battens.